



**The new era for cataract and  
refractive lens exchange surgery**



## WHAT IT IS:

### A Novel Intra-ocular Implant that Optimizes Your IOL Performance

fixOflex™ is a definitive solution to complications associated with human lens capsule deformations following cataract and refractive lens exchange treatments. When it comes to ophthalmic implants, fixOflex™ stands in a league of its own. Shaped like a torus with a perfect balance of stability and flexibility, fixOflex™ is a medical device used during cataract and/or refractive lens exchange surgery prior to IOL implantation. Meticulously crafted using CNC machines, fixOflex™ has a mean overall diameter of 9.8mm in its hydrated state and is made from hydrophilic acrylic, a time-tested material widely used in IOL manufacturing.

#### Remarkable design for unmatched performance

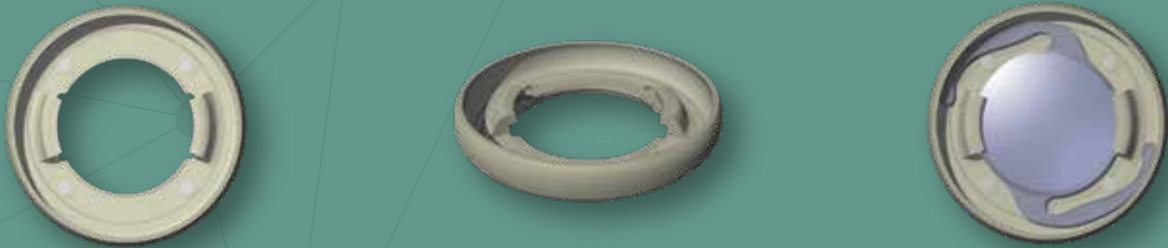

Experience the breakthrough innovation of fixOflex™ and transform the way you approach cataract and refractive lens exchange surgeries.

Selected as one out of three innovation presentations for the Session: "Expanding advanced cataract extraction- Robotic Femtophaco, automated capsulotomy and key postop refractive considerations" in Innovation Day ESCRS 2022

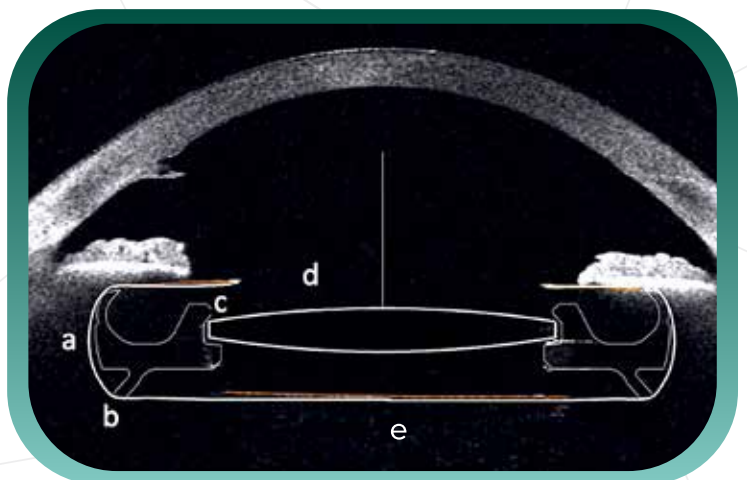
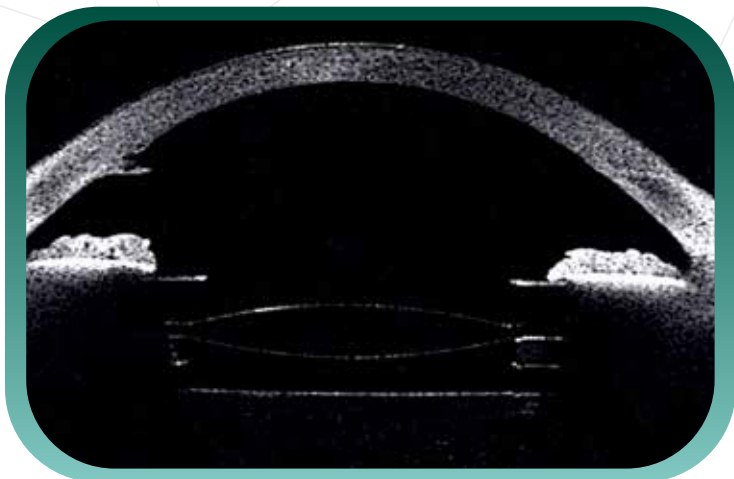

- a) Reconstruction / refilling of the peripheral capsule, helps keep the capsule open and reference the IOL plane in a well-determined plane.
- b) Mechanical barrier to cell migration.
- c) Clips that hold the optic of the IOL centered and at a predetermined axial location with respect to the equator.
- d) Open capsulorhexis.
- e) Stretched posterior capsule.

## WHAT IT DOES:

### Redefines Surgical Excellence For Enhanced Vision Restoration

Thanks to its outer rim's flexible parts, fixOflex™ adapts seamlessly to the size of the human lens capsule and mechanically stretches it to preserve the natural 3 dimensional state of the lens capsule and the intra-capsular volume. The inner opening of fixOflex™ accommodates IOLs with a 6mm optic diameter, allowing for compatibility with the majority of commercial IOLs. The inner rim of fixOflex™ incorporates additional structures designed to keep the optics in place, ensuring optimal stability and functionality of the IOL. This groundbreaking solution offers a multitude of benefits that will transform the way you approach cataract and refractive lens exchange surgeries.

### Revolutionary Benefits of fixOflex™

1

Circumferential barrier against cell migration and posterior capsule opacification (PCO)

2

Consistent "bed" for IOL placement

3

Secure IOL replacement at any time

4

Partial prevention of forward movement of vitreous

5

Universal design that can be used with most IOLs

6

Preliminary clinical and laboratory research indicate elimination of the effects of dysphotopsias

Embrace the future in IOL implantation with fixOflex™ and redefine excellence in ophthalmic surgery

## Research - Clinical Investigations

The initial trial to evaluate the safety and efficacy of fixOflex™ in 120 patients, launched in December 2019 at the Alexandria University, Egypt (Principal Investigators: Prof. Ahmed Elmassry and Prof. Osama Ibrahim) and was completed in June 2022.

Main outcomes exhibited no PCO after 1 year as compared to control group, BCDVA improvement up to 3 months and stability thereof, and Refractive Surprise stability from week 1.

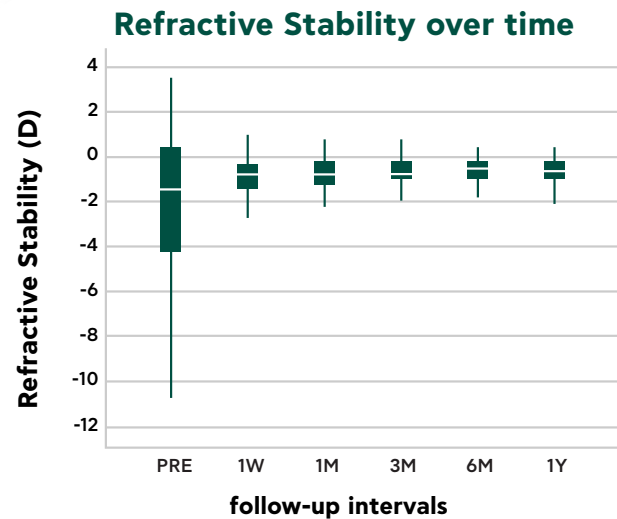
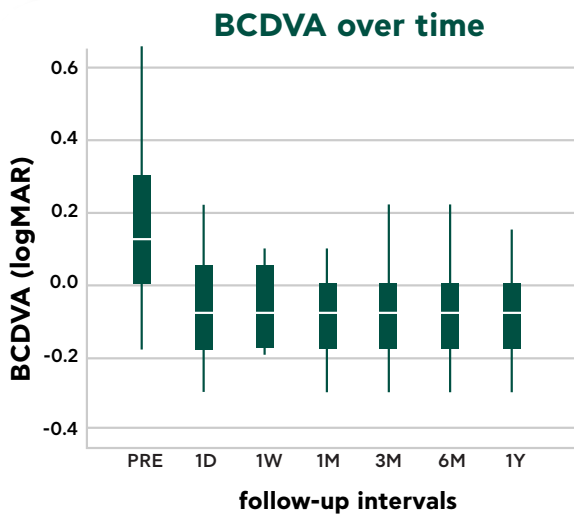
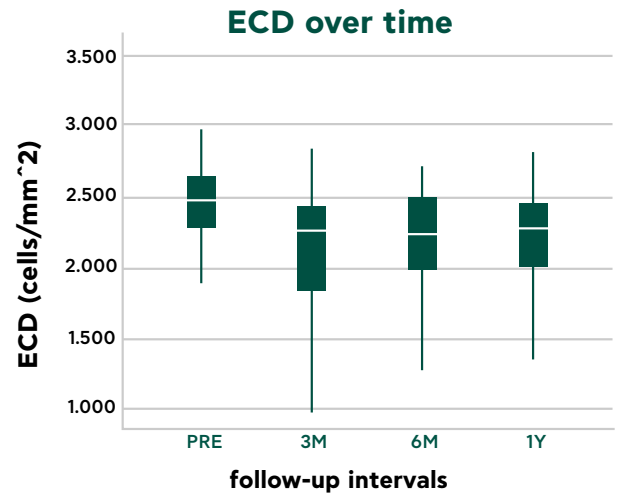
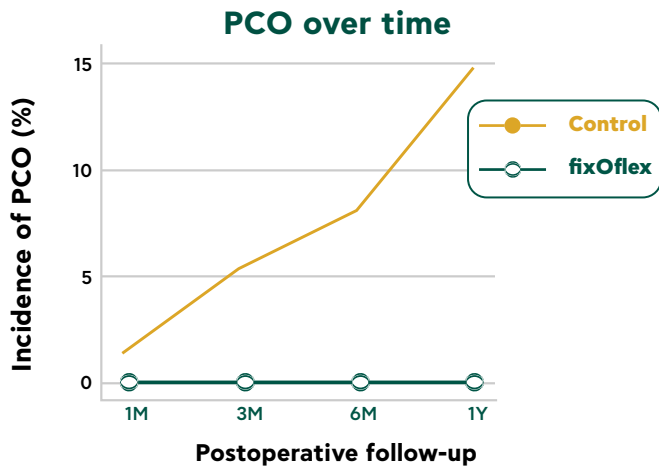

### Conferences and References:

ESCRS 2020, ARVO 2021, ESCRS 2021, ASCRS 2021, AAO 2021, ESCRS 2022, AAO 2022, ARVO 2022

Elmassry A, Sahin O, Leonidou L, Liakopoulos D, Ginis H, et al. (2020). Preservation of capsular transparency and geometrical consistency in cataract surgery using a novel intracapsular ring. J Clin Res Ophthalmol. 7(2): 101-104. DOI: 10.17352/2455-1414.000082

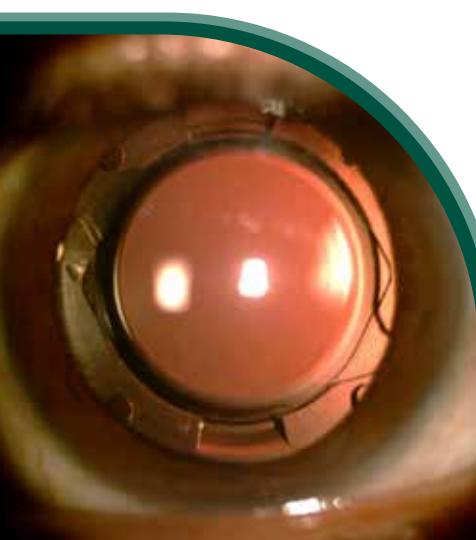

# EYE PCR

## Pioneering a new chapter in eye care

At our core, we are driven by a profound commitment to safeguard the invaluable gift of vision. Through relentless scientific research and unwavering dedication, we strive to optimize your IOL performance.

Our vision is to establish an esteemed scientific environment built on trust and driven by a passion for innovation. Our mission is clear: to bring extraordinary science to life-changing therapies for patients with eye disorders.

Located at the intersection of innovation and health, EYE PCR is at the forefront of ophthalmological advancements. Since our establishment in 2018, we have been driving the future of cataract and refractive lens exchange surgery, building upon the visionary work of Professor Ioannis Pallikaris. Since 1989, Professor Ioannis Pallikaris has been a pioneering leader in the research of LASIK, bringing over thirty years of experience and discovery to this promising new medical device. His original concept of creating an end-capsular open torus has paved the way for definitive solutions to complications associated with cataract and refractive lens exchange treatments.



Join the **fixOflex™** revolution and optimize your patients' IOL performance



## EYE PCR

**Headquarters:** Westerdoksdijk 423, 1013 BX, Amsterdam, The Netherlands

**Branch:** N. Plastira 100, Vassilika Vouton, GR-700 13 Heraklion – Crete, Greece

**Phone Number:** +30 2811 392101 **Email:** [info@eyepcr.com](mailto:info@eyepcr.com)

